



Semi Built-In / Telescopic Range Hoods

Installation Guide Operation Manual



IMPORTANT REMINDERS

USAGE

- This range hood has been designed for residential household use only.
- Commercial usage for café's, restaurants, and other similar establishments will void the warranty of this product due to excessive usage.
- Never use the range hood for purposes other than extracting kitchen smoke and odor.
- Never leave high open flames under the hood when it is in operation. Follow the minimum required distance from the cooktop for your safety.
- This range hood is not a toy. Please keep children and other unauthorized persons not instructed to use the hood away from the appliance.

INSTALLATION

- The manufacturer will not be held liable for any damages resulting from improper installation and/or misuse of the product.
- A qualified and authorized ELBA Service Technician must carry out the installation in order to properly secure the unit. Failure to do so can void the warranty, especially if the minimum requirements are not followed.
- The minimum safety distance between the cooktop and the range hood is anywhere from 600mm to 650 millimeters (mm), depending on the design of the upper kitchen cabinets. The distance is recommended to prevent open flames from burning the underside of the rangehood.
- Check that the electrical supply from the outlet to which the unit is to be plugged in is matching with the requirements of the hood, as indicated by the product label on the range hood.
- The exhaust pipe should have a minimum diameter of 12 centimeters (cm) to properly vent out the volume of air that the motor produces. Reducing the size of this will void the warranty of the product and will shorten the lifespan of the motor, due to backpressure and constricted airflow.

MAINTENANCE

- Switch off and unplug the appliance from the main power supply before carrying out any maintenance work.
- Clean the hood using a damp cloth and a neutral liquid detergent.
- Clean and/or replace the filters after the specified time period.
- There is risk of fire if cleaning is not carried out in accordance with the instructions in the Cleaning and Maintenance section of this manual.

LIABILITY

- The Distributor will not be held liable for any personal or physical damages incurred as a result of the improper installation, usage, and/or (lack of) proper maintenance of the product.

INSTALLATION

GUIDELINES

To ensure safety and best performance, the hood should be placed at a minimum recommended distance of 60 to 65cm from the cooking surface.

- The indicated range above is stated to prevent potential damages to the underside of the hood if/when an open flame occurs (for gas powered cooking appliances).
- Mounting the hood at a higher (greater than 65cm) distance will reduce the performance of the hood, as the effective suction power won't be as efficient in terms of covered distance.

INSTALLATION TYPE

DUCTING / EXTRACTION

If using as ducted installation, the exhaust pipe should have a minimum diameter of 12 centimeters (cm) to properly vent out the volume of air that the motor produces. Reducing the size of this will void the warranty of the product and will shorten the lifespan of the motor, due to backpressure generated by the motor and the overall constricted airflow. Use an extension hose (either plastic or aluminium) to connect the top of the motor exhaust provision to the exhaust pipe located at the wall or ceiling of the installation site. Secure this with tape or cable ties.

- Avoid too many bends when installing the exhaust pipe in order to ensure smooth airflow and reduce noise. Use angled bends (45 degrees), instead of corner bends (90 degrees) to ease airflow.
- It is recommended for this product to have its own exhaust line (leading out of the house), as extracted smoke and odor from the kitchen might spread to different areas if other auxiliary exhaust vents are connected.
- Charcoal Filters (if equipped) can be used with this type of installation to further help minimize kitchen smell and odor, aside from extracting it out.

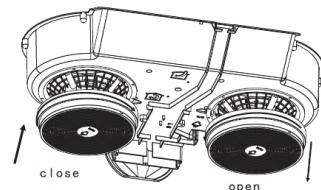

INSTALLATION

Under Cabinet Mounting

1. Center the unit in the area of installation and cut a hole to fit the exhaust pipe with at least 12cm diameter. It is advisable to cut a larger hole (around 15cm) so that the installer can have enough space to work and secure the ducting pipe to the duct pipe adaptor.
2. Drill four (4) holes at the bottom of the upper shelf based on the mounting pattern as seen on the topside of the range hood.
3. Align the hood with the drilled holes and tighten the screws.
**Only use screws specified for wood applications and ensure proper length.*
4. Make sure the unit is safely secured and properly levelled before use.
5. Ensure that the retractable portion of the hood does not hit the cabinet doors when either opened or closed.

Wall Mounting

1. Drill four (4) holes on a hard and sturdy surface (with bracing if possible) based on the mounting points of the rear of the hood.
2. Insert a tox into the drilled holes and ensure that this is properly embedded in the bored holes.
3. Insert the two (2) screws into the tox in order to mount the hood onto the desired location, tightening only until $\frac{3}{4}$ of the length of the provided screws.
4. Put up the range hood onto the fixed screws and tighten to make sure the unit is properly secured.
5. Insert the remaining two (2) screws to further secure the unit.
6. Make sure that the range hood is aligned properly, not tilted in either a sideward or front/backward direction, to prevent movement as this unit generates some vibration when turned on.

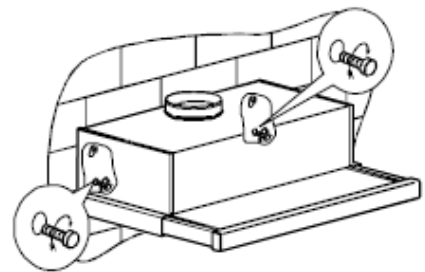
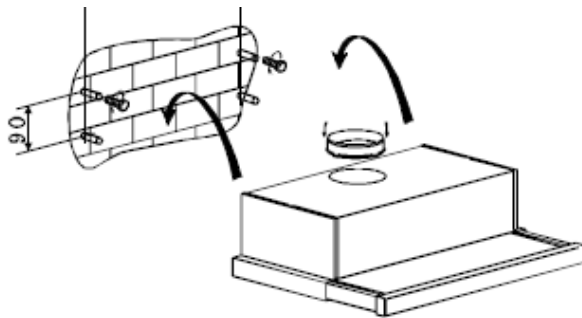

OPERATION

Note: Please check the applicable type of control present in your unit.

A.) Touch Control



Display Symbols:

- Speed Setting 1
- Speed Setting 2
- Speed Setting 3
- Light Setting Indicator
- Timer Setting Indicator

Touch Control Operation

- “” or “” or “” – Press either speed setting number control once to activate motor and selected speed setting. Press again to turn off and deactivate motor.
- “Light ” – Press to activate and deactivate light.
- “Timer ” – Press this button to activate the auto shutoff timer while the hood is in use and it automatically turns off the hood after 5 minutes. Press again to deactivate function.

B.) Slide Switch Controls

The frontal telescopic portion of the range hood acts as the main ON/OFF switch to the unit so the speed settings can be left at their

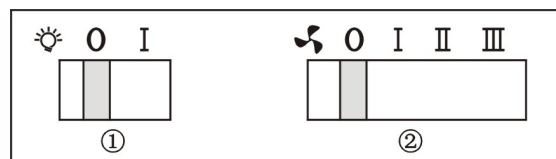

desired settings without physically sliding it to the “0” position after every use. Pulling out the frontal portion will trigger the unit to turn on, while pushing it back in will turn it off automatically. To access the controls, retract the frontal portion out and select the default desired speed / light settings.

Exhaust Control

- “0”, slide switch to this position to turn off unit
- “1”, slide switch to this position to activate speed setting 1
- “II” slide switch to this position to activate speed setting 2
- “III”, slide switch to this position to activate speed setting 3

Light Control

- “0”, slide switch to this position to turn off the light

- “1” slide switch to this position to turn on the light

CLEANING AND MAINTENANCE

Aluminium Filters

This unit comes equipped with 5 layer aluminium filters that collect and trap oil and grease from your daily cooking usage. These are to be cleaned on a regular basis in order to maintain the suction performance the hood.

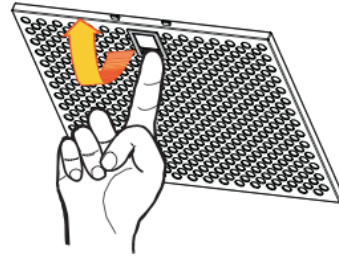

Removal Instruction

To remove the filters, press the clip located at the ends of the filter, pull down the filters, and release the clip.

Cleaning the Filters

1. Prepare a large basin with 40-60 degrees Celsius of warm water and add a mild dishwashing detergent to mix with the water.
 - Note: DO NOT use any corrosive detergent when cleaning.
2. Soak the aluminium filters for two (2) to five (5) minutes in the basin to loosen the build-up of oil and grease.
3. Use a soft brush with fine bristles to gently scrub the aluminium filters. Apply moderate strength, so as not to damage the filter.
4. Repeat the procedure until all the built up oil has been removed.
5. Allow the filter to air dry until it is completely free from any moisture before reinstalling it to the unit.

Recommendation

Clean your aluminium filters at least once every month, or twice a month for heavy usage. Remember that clogged filters reduce the suction capacity of the hood and might be a fire hazard, as excessive oil build-up is flammable and will definitely contribute to foul odor in the kitchen if left unattended. Visually inspect the filter for trapped oil and grease on a regular basis in order to maximize the performance of the hood.

Warranty Exemption

The aluminium filters are a consumable item and are not covered by the warranty of this item. Any defects caused by the negligence in cleaning the filters will also void the warranty of the product.

CLEANING AND MAINTENANCE

Charcoal / Carbon Filter (if equipped)

Activated carbon filter can be used to help trap odors generated from your daily cooking in the kitchen. The activated carbon filter are non washable and should be changed around three or six months according to your cooking habit or when you feel like it is no longer absorbing the smell in the kitchen. Note that since each user's sensitivity to smell is different, replacement schedule may vary from suggested timeline.

Warranty Exemption

The Charcoal Filters are a consumable item and are not covered by the warranty of the product.

LED Lights (equipped)

This unit comes equipped with energy efficient LED bulbs that help illuminate your kitchen workspace while cooking. If a bulb flickers, dims, or becomes busted over time, please call the service centre for the replacement of the lights.

Warranty Exemption

The LED bulbs are a consumable item and are not covered by the warranty of the product.

Cleaning the Body Casing

Before maintenance or cleaning is carried out, the cooker hood should be disconnected from the main power supply to avoid electric shock. External surfaces are susceptible to scratches and abrasions, so please follow the cleaning instructions to ensure the best possible result is achieved without damage.

1. Ensure that the hood is cool to the touch.
2. Use a soft damp cloth to wipe the body casing to remove dust particles and excessively oily surface residue.
3. Warm soapy water can be used to help loosen up built on surface grease. Wipe immediately after and make sure that the soap does not drip onto sensitive areas such as the control panel and lights.
4. After which, use a clean and dry cloth to wipe down any excessive moisture left by the damp cloth.
5. Always remember to wipe along with the grain of the surface to prevent crisscross scratch marks.
6. You may use a dedicated stainless steel cleaner (for stainless steel finishes) to finish off the cleaning process.
7. Certain parts of the hood are made from glass. As such, a dedicated glass cleaner (for glass surfaces) can be used to finish off the cleaning process.
8. Do not use harsh / aggressive chemicals containing abrasives and rough sponges that can damage the material finish of the range hood.